

# Pneumatic Diagram and Corresponding Catalog Pages

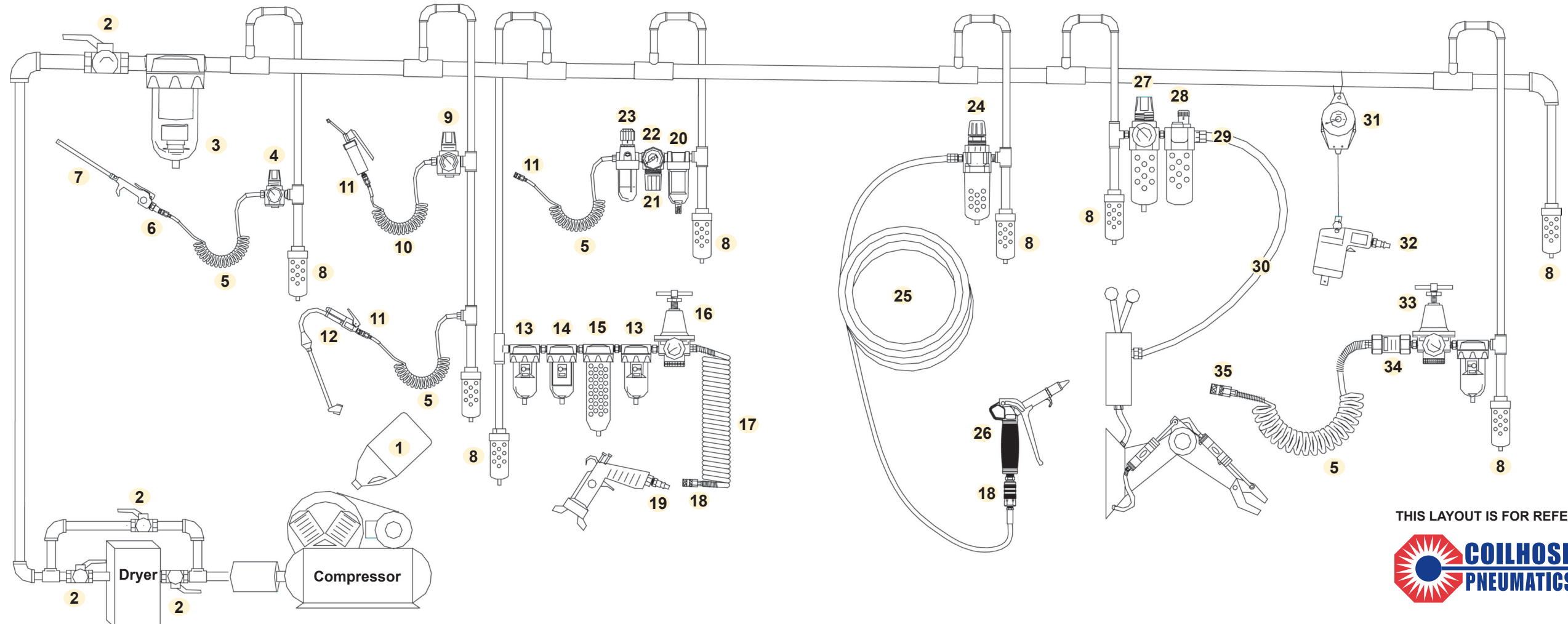

THIS LAYOUT IS FOR REFERENCE ONLY.

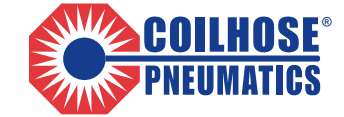

ITEM NO.	DESCRIPTION	CATALOG PAGE	DETAIL
1	Air Compressor Oil	82	Compressor oil is vital for trouble-free compressor operation.
2	Ball Valve	88	This valve opens or shuts-off air flow throughout the system.
3	Filter (General Purpose Series)	63	A high-volume, "first pass" filter that removes most moisture and impurities from the air system so that they do not foul downstream equipment.
4	Economy Regulator	44	This regulator provides users with accurate yet cost-effective air regulation.
5	Flexcoil® Polyurethane Hose	10	This 125 PSI-rated coiled hose is lightweight, extremely durable and kink and abrasion resistant. This assembly also features pigtailed for maneuverability.
6	Industrial Interchange Coupler & Connector	26,28	Available in 1/4" to 3/4" NPT body sizes. This is a very popular interchange for industrial applications.
7	600 Series Blow Gun with Extension	35	Blow guns are a common accessory used to blow debris, shavings, and chips away from work surfaces. The 600 Series guns are made of tough zinc die cast bodies.
8	Mechanical Condensate Drain	65	Found at the bottom of drop legs. Used to trap moisture and vent it out of the air system.
9	Miniature Series Regulator	47	Regulators control air pressure and protect tools from over pressurization.
10	Flexeel® Polyurethane Reinforced Coiled Air Hose	14	Flexeel® is extremely lightweight and combines the durability of bulkier hoses with the kink resistance and elasticity of polyurethane to make a tough, long lasting hose.
11	Automotive / Tru-Flate Interchange Coupler & Connector	29	Available in 1/4" to 1/2" NPT body sizes. This is a very popular interchange for automotive and shop applications.
12	Tire Inflator Gauge	87	Used to inflate tires.
13	Heavy Duty Filter (88 Series)	60	This filter removes additional moisture and impurities from the air system and is used downstream, close to the tool or application.
14	Heavy Duty Coalescing Filter (88 Series)	60	This filter is employed downstream of other, standard filtration. It removes 99.97% of solids and fluids and is used where very clean air is required.
15	Dessicant Dryer	65	This dryer collects any moisture remaining in the air stream after filtration.
16	Heavy Duty Regulator (88 Series)	61	Regulators control air pressure and protect tools from overpressurization. They also improve the efficiency of air systems.
17	Nylon Self-Storing Air Hose	6-8	This hose is lightweight, chemical-resistant and designed to withstand high temperatures.
18	Megaflow™ Coupler	31	Megaflow™ couplers are the size of a 1/4" body coupler but have the flow of a 3/8" coupler. This series is often used in the PB&E market, or in any application requiring high flow.

ITEM NO.	DESCRIPTION	CATALOG PAGE	DETAIL
19	Megaflow™ Ball Swivel Connector	31	This item combines the high flow characteristics of the Megaflow™ coupler and the ergonomics of a ball swivel connector.
20	Mini Filter	46	This filter removes additional moisture and impurities from the air system and is used downstream, close to the tool or application. The Modular Series of FRLs is used when easy assembly / disassembly is required.
21	Mini Regulator	47	Regulators control air pressure and protect tools from over pressurization.
22	Gauge	48	Gauges measure pressure throughout an air system.
23	Mini Lubricator	47	Lubricators provide the required lubricant needed to protect tools and pneumatic devices downstream.
24	Modular Integral Filter / Regulator (27 Series)	59	This item combines the features of a regulator and filter in one space-saving unit. The modular design makes installation easy.
25	Flexeel® Straight Hose	16	This is the most flexible, lightweight, durable, reinforced air hose available. An excellent alternative to bulkier rubber and plastic hoses.
26	Typhoon™ Blow Gun	39	This high-volume blow gun combines heavy-duty blow-off with pistol-grip ergonomics.
27	Compact Integral Filter / Regulator (26 Series)	56	This compact item combines the features of a regulator and filter in one space-saving design.
28	Compact Lubricator (26 Series)	55	Lubricators provide the required lubricant needed to protect tools and pneumatic devices downstream.
29	Coilock™ Push-to-Connect Fittings	73-74	These push-to-connect or "push-in" fittings work with nylon, polyurethane, and polyethylene tubing.
30	Plastic Tubing	68-71	CoilHose has a wide selection of plastic tubing to be utilized within an air system.
31	Tool Balancer	90	Tool Balancers suspend tools at the work station, reducing user fatigue.
32	ARO Interchange Connector	30	Available in 1/4" NPT body size, this is a popular connector used with lubrication and spray equipment.
33	Heavy Duty Tamperproof Regulator (88 Series)	61	This regulator features a removable "T handle key." Once the desired pressure is set, the key can be removed, eliminating unauthorized adjustment.
34	Safety Excess Flow Check Valve	89	This valve is placed between the supply main and the air hose. It automatically shuts off flow in the event of a sudden break in the air line.
35	ARO Interchange Coupler	30	Available in 1/4" NPT body size. Typically used with lubrication and spray equipment.